

## Coding System K

for coding of our printed circuit board plug-in connector family.

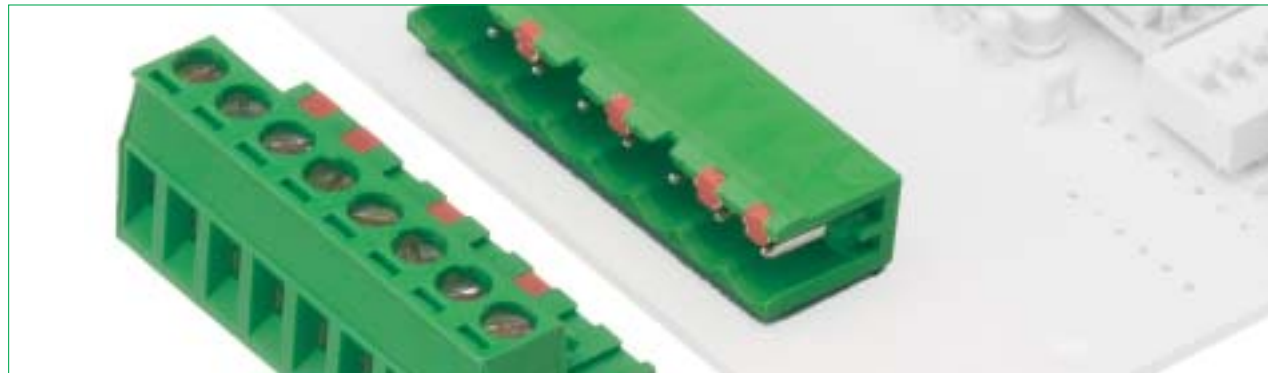

The **CONTA-CON** coding system K is intended to enable the user to encode our P.C. board plug-in connectors **PKB 950/960/1100/1110/1550/1551/ 1552, PBT 1200** and **PZB 3950** without loss of poles and incorrect plugging.

The coding elements [profiles] are fastened to the star-shaped mounting plates. Mechanical coding is effected by positioning the individual coding profiles in the patchboard.

These coding profiles are pushed into the respective guide grooves in the enclosure of the connector and header and pinched off to separate them from the mounting plate.

Types 1550, 1551, 1552, 1570 and 1590 however are an exception because, in their case, coding is effected by placing the coding profiles into the groove of the plug header.

Connectors have "lugs" at their enclosures which permit easy removal and individual coding.

**Coding system K** is designed for coding of P.C. board plug-in connectors without loss of pole.

The coding matrix on the next page is intended to illustrate the respective combinations possibilities.



**Coding K1**  
for coding of connectors

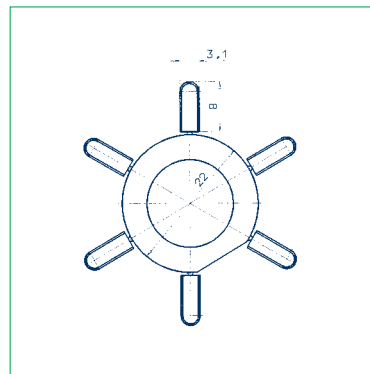

**Cat.-No. 12002.9**  
Qty. p. pck. 100 stars (600 tabs)



**Coding K2**  
for coding of headers

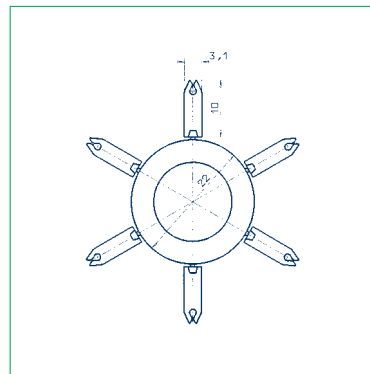

**Cat.-No. 12003.9**  
Qty. p. pck. 100 stars (600 tabs)



**Coding K3**  
for coding of headers type  
**STL 1550, 1570, 1590**

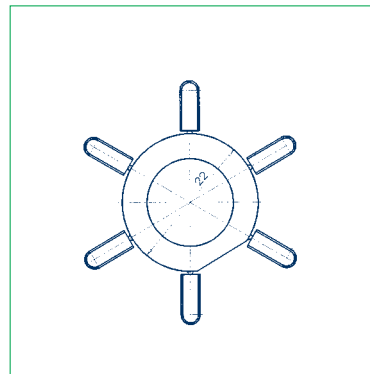

**Cat.-No. 12004.9**  
Qty. p. pck. 100 stars (600 tabs)

## Coding System K

Coding possibilities of connectors and headers of the **CONTA-CON** P.C. board plug-in connector system family.

CONNECTORS	HEADERS								
		STL 950	STL 960	STL 970	STL 975	STL 990	STL 1550	STL 1570	STL 1590
PKB 950	K1	K2		K1	K2	K1			
PKB 960			K1						
PKB 1100	K1	K2		K1	K2	K1	K2		
PKB 1110	K1	K2		K1	K2	K1	K2		
PBT 1200	K1	K2		K1		K1	K2		
PZB 3950	K1	K2			K1	K2			
PKB 1550							K3	K3	K3
PKB 1551							K3	K3	K3
PKB 1552							K3	K3	K3

## AD/PK

### Individual shrouding cover

According to various VDE requirements, mains terminals have to be equipped with a shrouding cover in addition to an IP 20 protection. Single shrouding cover **AD/PK** is available for printed circuit board connector **PK 750** and printed circuit board plug-in connector [connector] **PKB 950**.



**Type AD/PK yellow**  
**Cat.-No. 13283.8**  
Qty. p. pck. 100 pcs.



Ex. **AD/PK** on **PK750**

## BLS-STL

### Filler plugs to subdivide headers

Filler plug **BLS-STL** is used to subdivide relatively long headers into several sections.

Furthermore this serves to clearly sectionalize relatively long headers.

**Protection against incorrect connection**  
Protection of individual headers against dust and touching.



**Type BLS-STL**  
**Cat.-No. 13284.1**  
Qty. p. pck. 100 pcs.



Ex. **BL-STL**